

POLYMAT ROOF

PREFAB ROOFING PANELS (Inverted Roof - Exemplary)

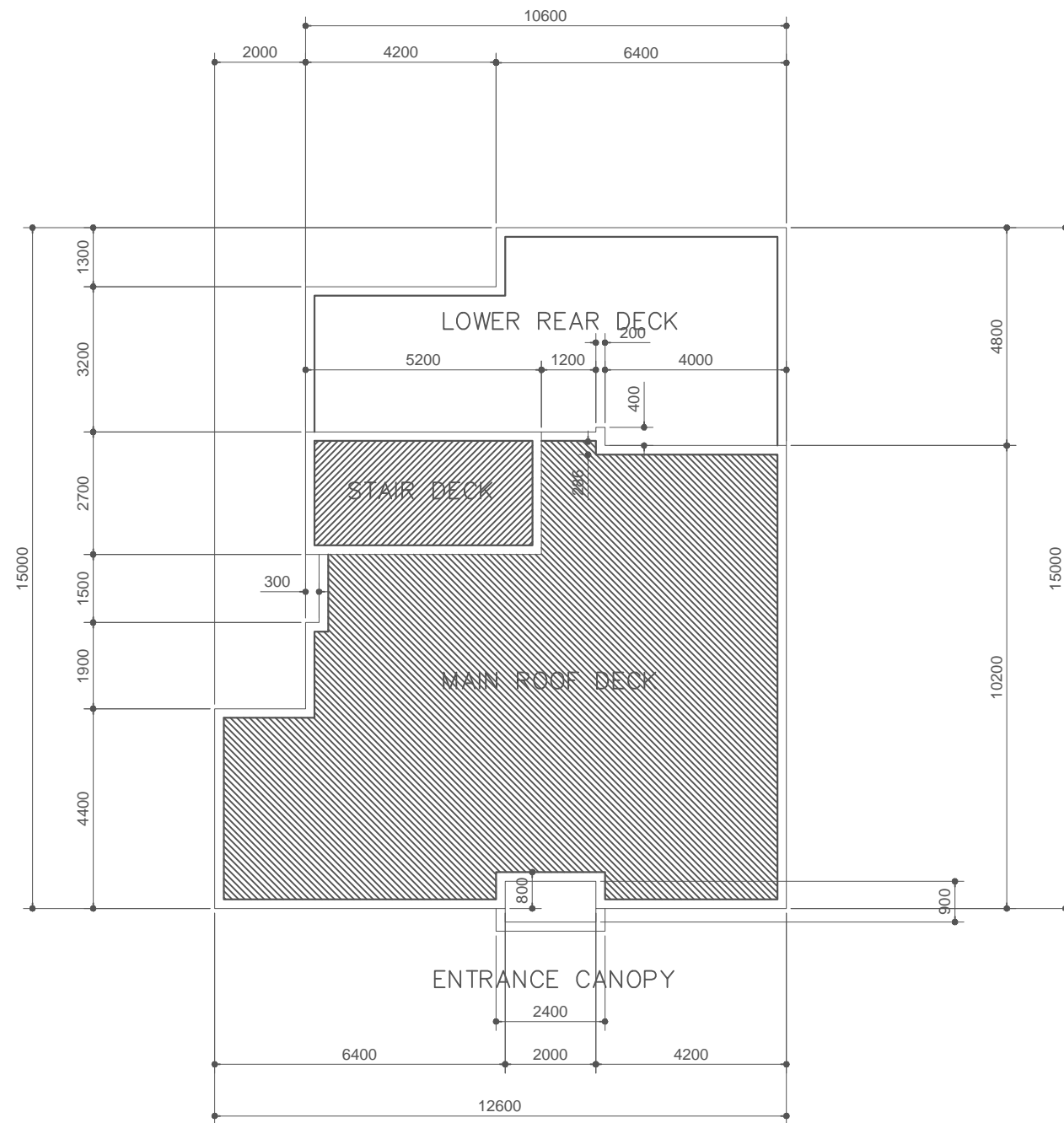

ROOF DECK

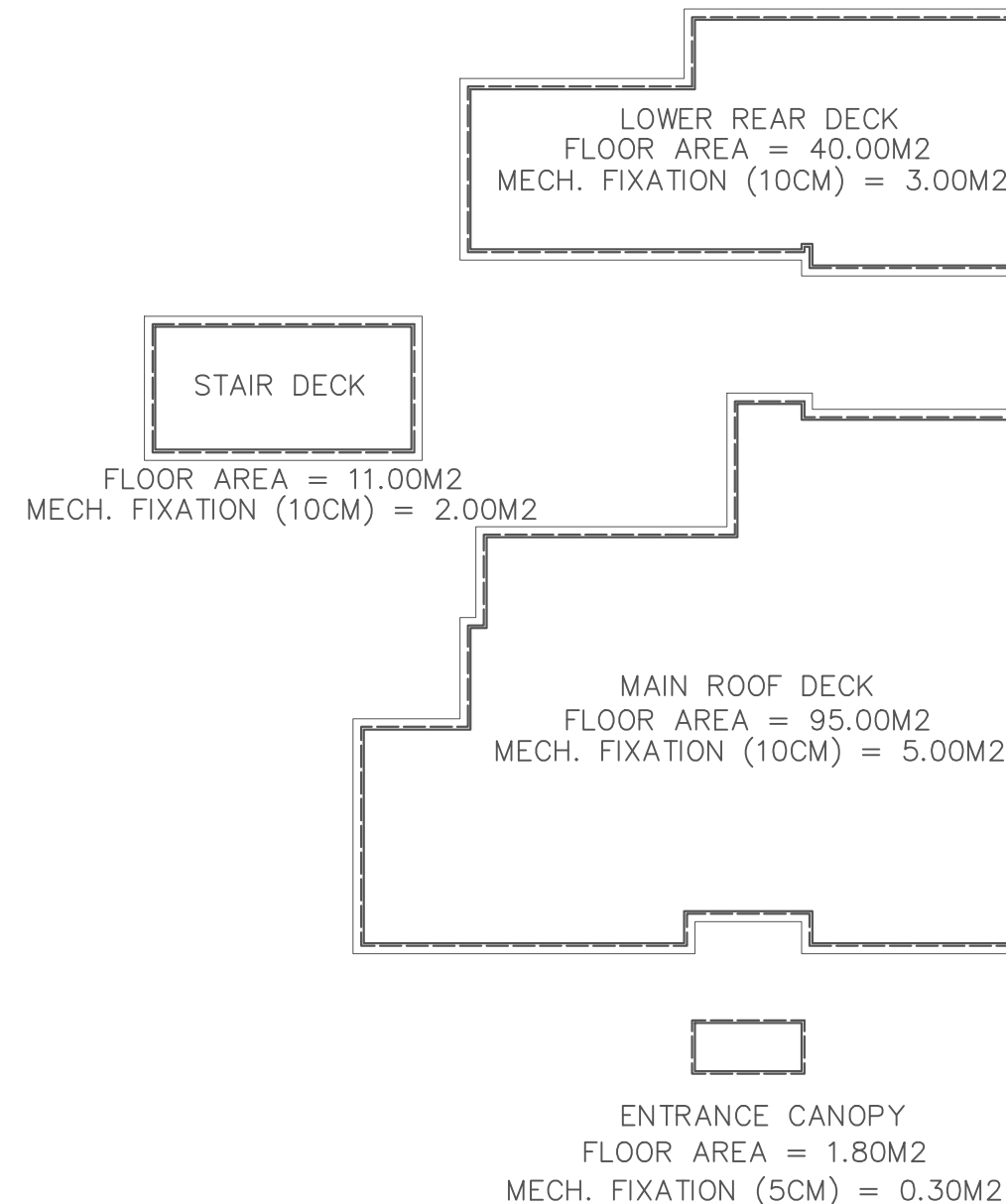

ROOF OUTLINE (Exemplary)

UPSTAND/MECH.FIXATION=5.00m2
EFFECTIVE ROOF SURFACE=150.00m2
ROOF AREA=155.00m2
(HORIZONTAL, INCLUDING MECH. FIXATION)

DRAWING TITLE	REMARKS	REVISION	DRAWN BY :	DWG. No.
POLYMAT PVC - SINGLE PLY (Inverted Roof) Pre-Fabricated Panels	EXEMPLARY FOR COMPOUND HOUSING PROJECTS (Multiple No. of Houses)	0.0	CHECKED BY :	MS.01.02-10
		DATE :	DATE :	
		REF. NO.		